

LR16C INTERIOR LINEAR RIGID

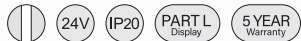

R + R



Colour-Matched. Precision-Cut. Quality-Assured. Built to Blend. Install-Ready.

Trusted by designers for precision, consistency, and total system integration. Our updated and extended Linear range brings that same expertise to flexible and rigid luminaires, giving you the freedom to create clean, continuous lines of light, perfectly matched in colour, quality, and performance across every application.

The LR16C is a dedicated profile designed to deliver seamless transitions and continuous lines of light in corners.

Built for uniformity, reliability, and visual control, the LR16C maintains exacting colour consistency and ensures continuity across every detail of the design.

Engineered, manufactured, and tested in-house, it provides up to 2m of continuous light, precision-cut to 1mm accuracy and supplied as IP20 for interior architectural applications.



KEY FEATURES

- > Colour-matched to the full LightGraphix range for uniform illumination across all luminaire types
- > Corner profile for clean internal and external junctions with continuous lines of light
- > 24V DC system allowing long lengths from a single driver
- > Colour-matched LEDs within 2-step MacAdam ellipse
- > Continuous lengths up to 2m; 1mm cut accuracy
- > Wide CCT range from 2200K - 6000K
- > IP20 as standard
- > Matching flexible profile: LF10D
- > Range of mounting options
- > Dimming: 0-10 V, DALI, Casambi, DMX, Mains
- > Engineered, manufactured, and tested in the UK







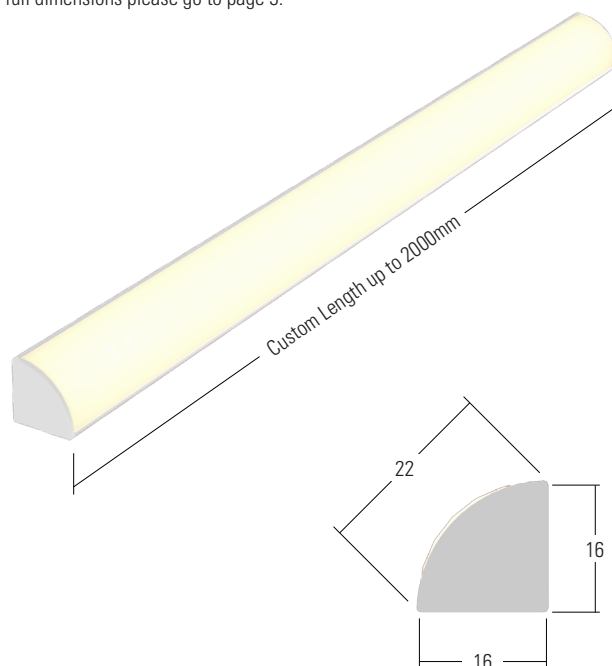

DIMENSIONS

Dimensions in mm

For full dimensions please go to page 3.



WHITE LED ENGINE SPECIFICATION

Engine	 LT500	 LT900	 LT1400	 LT2000
Colour temperature*	2200K, 2400K, 2700K, 3000K, 4000K, 5000K	2200K, 2400K, 2700K, 3000K, 4000K, 5000K	2200K, 2400K, 2700K, 3000K, 4000K, 5000K	2200K, 2400K, 2700K, 3000K, 4000K, 5000K
Typical LED Circuit Wattage/m	3W	6W	9W	13W
Delivered lumens (L ₁₀₀)*	341	681	1022	1413
Delivered lm/Circuit W**	103	103	102	99
Source LED lm/m	494	987	1481	2048
Source lm/W	165	165	165	158
Forward voltage (V ₁₀₀)	24V			
CRI	90+			
LOR	0.69			
Colour Consistency	2 SDCM			
LED Lifetime	L80B50 at 50,000hrs			
Applications	   			

These values are based on LR16C/3000K/1000mm

*See lumen variance table to the right for lumens apply across all colour temperatures

**LED wattage includes losses associated with using a 90% efficient driver

Lumen variance by CCT	
2200K	-20%
2400K	-11%
2700K	-4%
3000K	0%
4000K	3%
5000K	6%

MECHANICAL

Ambient temperature	-20°C to 45°C*
Materials	Anodised Aluminum 6063 profile, polycarbonate Opal Diffuser, polycarbonate end caps, Stainless steel brackets
Weight of product (per m)	0.22Kg/m
IP rating	IP20
Cable	Pre-Wired 2 core silicon cable 1000mm**
Wiring	Parallel constant voltage wiring 24V
Max. Installed Length	2m





*For higher temperatures please contact sales@lightgraphix.co.uk

**Custom length on request

ENVIRONMENTAL

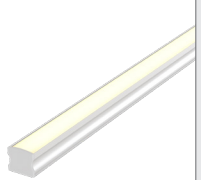
TM65	Available on request
TM66	1.9
Repair + Refurbish	 <p>This product is included in our Repair and Refurbish scheme. This offers customers the ability to send back products to us for repair or refurbishment to extend their life without having to buy new fittings.</p>

LINEAR RIGID RANGE OVERVIEW

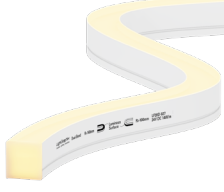
	LR12	LR12T	LR16C	LR17	LF20
					
Size	15mm x 12mm	15mm x 18mm	16mm x 16mm	16mm x 17mm	20mm x 20mm
Applications	<ul style="list-style-type: none"> > Interior > Surface Mount > Cove & Contour > Display & Shelf > Low Depth 	<ul style="list-style-type: none"> > Interior > Surface Mount > Cove & Contour > Display & Shelf > Low Depth 	<ul style="list-style-type: none"> > Interior > Surface Mount > Cove & Contour > Display & Shelf > Low Depth 	<ul style="list-style-type: none"> > Interior > Surface Mount > Cove & Contour > Display & Shelf > Low Depth 	<ul style="list-style-type: none"> > Interior > Surface Mount > Cove & Contour > Display & Shelf > Low Depth
IP Rating	IP20	IP20	IP20	IP20	IP20
Lumen/m	500-2000	500-2000	500-2000	500-2000	500-2000
Wattage/m	3-13W	3-13W	3-13W	3-13W	3-13W
CRI	90	90	90	90	90
CCT	2200K, 2400K, 2700K, 3000K, 4000K, 5000K	2200K, 2400K, 2700K, 3000K, 4000K, 5000K	2200K, 2400K, 2700K, 3000K, 4000K, 5000K	2200K, 2400K, 2700K, 3000K, 4000K, 5000K	2200K, 2400K, 2700K, 3000K, 4000K, 5000K
Dynamic options			 Tunable white, RGBW	 Tunable white, RGBW	 Tunable white, RGBW
Rigid Version	LF10	N/A	N/A	LF16D	LF20D
					

THE LINEAR RANGE THAT YOU WOULD EXPECT FROM LIGHTGRAPHIX

Trusted by designers for precision, consistency, and total system integration. Our updated and extended Linear range brings that same expertise to flexible and rigid luminaires, giving you the freedom to create clean, continuous lines of light, perfectly matched in colour, quality, and performance across every application.

Colour-Matched

Developed using LightGraphix-engineered LED tape, tightly binned within a two-step MacAdam ellipse. Every luminaire is visually and chromatically matched across our full range from downlights and uplights to spotlights and linear delivering consistent light quality and tone throughout the project.

Precision-Cut

Every fitting is made to measure in our UK operations - cut, connected, moulded, and IP-tested in-house. With 1mm cutting accuracy and continuous lengths up to 2m, each product delivers technical precision and a flawless finish, ensuring your specification is realised exactly as intended.

Quality-Assured

Engineered with the same design principles and light engines as our flexible range, every LightGraphix Linear Rigid fitting undergoes full in-house quality testing to ensure output consistency, colour uniformity, and long-term thermal stability. Designed for longevity and absolute trust in architectural environments.

Built to Blend

Designed to give you ultimate flexibility for your lighting design, each Linear product integrates seamlessly with our wider portfolio. Flexible and Rigid options share the same light engines, allowing continuous lines of light that sit discreetly within the architecture and maintain design integrity.

Install-Ready

Engineered, assembled, and tested through our UK operations for dependable performance and rapid turnaround. Custom lengths, pre-moulded connections, and a 5-year warranty reduce on-site work, minimise risk, and ensure every luminaire arrives ready to install.

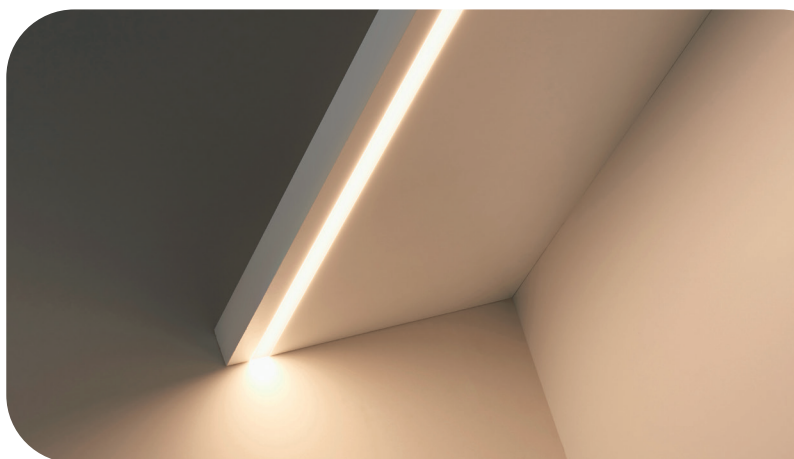
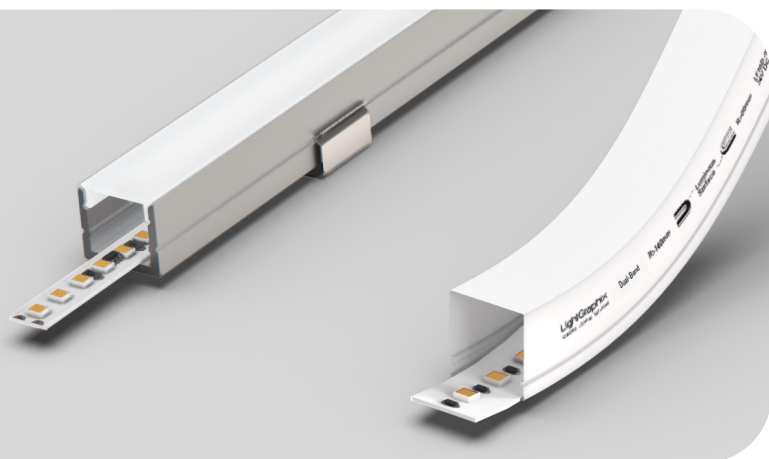

DIMENSIONS AND FIXING ACCESSORIES

Dimensions in mm

/NF No fixing

No fixing supplied. Product is bonded directly into mounting surface. Ideal for routed grooves in 30mm thick shelves.

/SC Spring Clips

Stainless steel fixing clips are ideal for exterior environments. For example under steps or around water features.





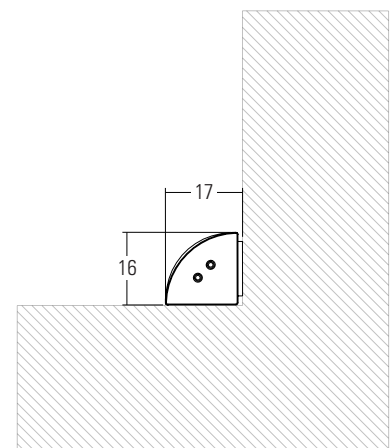
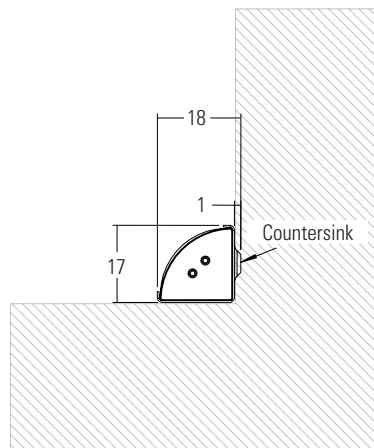
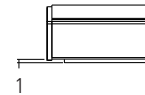
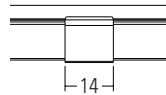
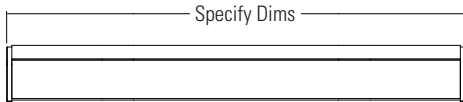
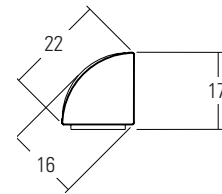
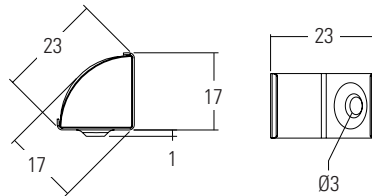
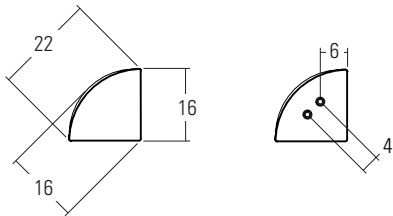
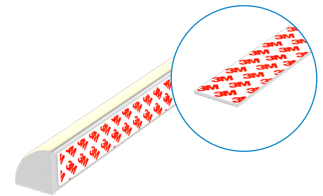
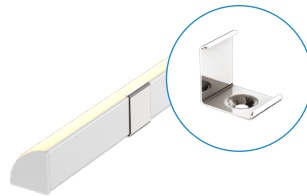
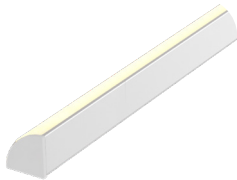

























/3M 3M adhesive tape

3M adhesive tape is suitable for most applications and will provide a very good bond to metal, wood and painted surfaces. 1mm thickness allows for any bumps in the mounting surface. Ideal for routed grooves where the fitting needs to sit flush. Indoor only applications.



ORDER CODES & OPTIONS

Example: LR16C-LT500/927/SC/2000mm

Light Engine & Drive Current	LED Colour	Fixing & Profiles	Length (2000mm Max)																																																														
<input type="text"/>	<input type="text"/>	<input type="text"/>	<input type="text"/>																																																														
<table border="1"> <tr> <td> LT500</td> <td></td> <td></td> <td></td> </tr> <tr> <td>24V 3W/m</td> <td>LR16C-LT500</td> <td rowspan="6">  /NF  /SC  /3m </td> <td></td> </tr> <tr> <td></td> <td>Super Warm White (2200K) /922</td> <td></td> </tr> <tr> <td></td> <td>Very Warm White (2400K) /924</td> <td></td> </tr> <tr> <td></td> <td>Extra Warm White (2700K) /927</td> <td></td> </tr> <tr> <td></td> <td>Warm White (3000K) /930</td> <td></td> </tr> <tr> <td></td> <td>White (4000K) /940</td> <td></td> </tr> <tr> <td colspan="4"> <table border="1"> <tr> <td> LT900</td> <td></td> <td></td> <td></td> </tr> <tr> <td>24V 6W/m</td> <td>LR16C-LT900</td> <td></td> <td></td> </tr> <tr> <td></td> <td>Cool White (5000K) /950</td> <td></td> </tr> </table> </td> </tr> <tr> <td colspan="4"> <table border="1"> <tr> <td> LT1400</td> <td></td> <td></td> <td></td> </tr> <tr> <td>24V 9W/m</td> <td>LR16C-LT1400</td> <td></td> <td></td> </tr> </table> </td> </tr> <tr> <td colspan="4"> <table border="1"> <tr> <td> LT2000</td> <td></td> <td></td> <td></td> </tr> <tr> <td>24V 13W/m</td> <td>LR16C-LT2000</td> <td></td> <td></td> </tr> </table> </td> </tr> </table>				 LT500				24V 3W/m	LR16C-LT500	 /NF  /SC  /3m			Super Warm White (2200K) /922			Very Warm White (2400K) /924			Extra Warm White (2700K) /927			Warm White (3000K) /930			White (4000K) /940		<table border="1"> <tr> <td> LT900</td> <td></td> <td></td> <td></td> </tr> <tr> <td>24V 6W/m</td> <td>LR16C-LT900</td> <td></td> <td></td> </tr> <tr> <td></td> <td>Cool White (5000K) /950</td> <td></td> </tr> </table>				 LT900				24V 6W/m	LR16C-LT900				Cool White (5000K) /950		<table border="1"> <tr> <td> LT1400</td> <td></td> <td></td> <td></td> </tr> <tr> <td>24V 9W/m</td> <td>LR16C-LT1400</td> <td></td> <td></td> </tr> </table>				 LT1400				24V 9W/m	LR16C-LT1400			<table border="1"> <tr> <td> LT2000</td> <td></td> <td></td> <td></td> </tr> <tr> <td>24V 13W/m</td> <td>LR16C-LT2000</td> <td></td> <td></td> </tr> </table>				 LT2000				24V 13W/m	LR16C-LT2000		
 LT500																																																																	
24V 3W/m	LR16C-LT500	 /NF  /SC  /3m																																																															
	Super Warm White (2200K) /922																																																																
	Very Warm White (2400K) /924																																																																
	Extra Warm White (2700K) /927																																																																
	Warm White (3000K) /930																																																																
	White (4000K) /940																																																																
<table border="1"> <tr> <td> LT900</td> <td></td> <td></td> <td></td> </tr> <tr> <td>24V 6W/m</td> <td>LR16C-LT900</td> <td></td> <td></td> </tr> <tr> <td></td> <td>Cool White (5000K) /950</td> <td></td> </tr> </table>				 LT900				24V 6W/m	LR16C-LT900				Cool White (5000K) /950																																																				
 LT900																																																																	
24V 6W/m	LR16C-LT900																																																																
	Cool White (5000K) /950																																																																
<table border="1"> <tr> <td> LT1400</td> <td></td> <td></td> <td></td> </tr> <tr> <td>24V 9W/m</td> <td>LR16C-LT1400</td> <td></td> <td></td> </tr> </table>				 LT1400				24V 9W/m	LR16C-LT1400																																																								
 LT1400																																																																	
24V 9W/m	LR16C-LT1400																																																																
<table border="1"> <tr> <td> LT2000</td> <td></td> <td></td> <td></td> </tr> <tr> <td>24V 13W/m</td> <td>LR16C-LT2000</td> <td></td> <td></td> </tr> </table>				 LT2000				24V 13W/m	LR16C-LT2000																																																								
 LT2000																																																																	
24V 13W/m	LR16C-LT2000																																																																

Drivers

To be used with 24V constant voltage LED Drivers and Controllers, We offer a range of drivers with 1-10V, DMX, and DALI dimming options. Please download the data sheet from the downloads section at www.lightgraphix.co.uk, or contact us for more information.