

WARNING: DO NOT USE NORMAL LOW VOLTAGE TRANSFORMERS WITH LEDs.

All LED fittings are tested before dispatch. It is not necessary to check them on site. Do not power up until fittings are wired correctly.

INSTRUCTION LEAFLET



LD242A

LED Recessed Pool Light

This product should be installed by a qualified electrician in accordance with all current, local legislation. For the UK, the current edition of the IEE Wiring Regulations and European Standard IEC 60364.

SPECIFICATION

LED recessed luminaires are class III  for Safety Extra Low Voltage supply  **350mA to 700mA** constant current supply.

Suitable for mounting on normally flammable surfaces. 

This fitting is **IP68** rated (up to a depth of 2 metres).

Lumen Maintenance: 50,000 hours L70 at Max Ambient of 35°C.

Product & LED output code	Power Output
LD242A - 350	350mA 1.2W
LD242A - 500	500mA 1.7W
LD242A - 700	700mA 2.4W

INSTALLATION

1. Bore clearance hole to suit dimensions below.
2. The /476 sleeve is designed to be a push in fit, but can be also glued in place. Install this first.
3. Wire the luminaire to a specified driver.
NOTE: Connections in wet environments. Make IP68 connection to stop water travelling up the cables into the fittings! Refer to IP connection sheet for further details.
4. Make sure 'O' rings are free from dirt and grit. A grease lubricant (such as vaseline) can be used to aid the installation of the /476 sleeve to the fitting.
5. Offer luminaire up to the sleeve and push in firmly until the bezel is flush with the mounting surface.
6. When installing LD242A, rotate the fitting using a grippy pair of gloves to orientate it.

DIMENSIONS

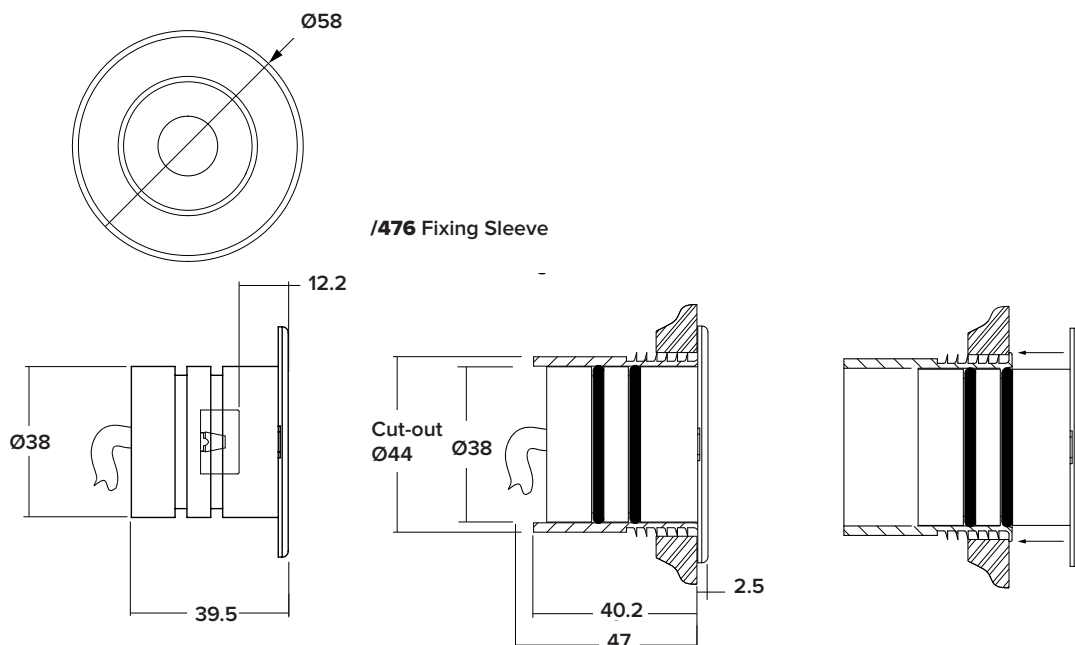

Note
LEDs with OB lens
(36° X 12° Degree beam)

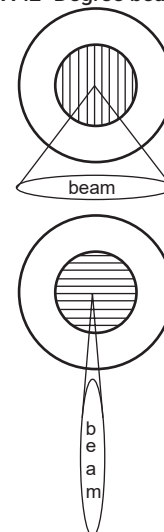

WIRING

Do not power up until fitting is wired correctly! Constant current LEDs must be wired in series, polarity is critical! Please refer to specified driver sheet for details on the minimum and maximum number of LEDs per circuit.

Single Colour LEDs		
Colour of Cable	Red	Black
Polarity	+	-

SEE CONSTANT CURRENT WIRING SHEET FOR IN SERIES WIRING DIAGRAM

IMPORTANT

Make sure that all cables and connections are securely connected before switching on the power. Do not switch on the power source prior to making these connections as this will result in the LEDs being overvolted, which can lead to failure of the LEDs and/or the driver. If the LEDs do not work upon power up, turn off the power source immediately and check the polarity of the wiring.

MAINTENANCE

LAMPS: Non Replaceable.
O-Ring replacement part N°: 17.0049
Clean with soft damp cloth.

This leaflet should be issued and retained by the end user.

WARNING: DO NOT USE NORMAL LOW VOLTAGE TRANSFORMERS WITH LEDs.

All LED fittings are tested before dispatch. It is not necessary to check them on site. Do not power up until fittings are wired correctly.

INSTRUCTION LEAFLET



LD242A RGB

LED Recessed Pool Light

This product should be installed by a qualified electrician in accordance with all current, local legislation. For the UK, the current edition of the IEE Wiring Regulations and European Standard IEC 60364.

SPECIFICATION

LED recessed luminaires are class III  for Safety Extra Low Voltage supply  **350mA** constant current supply.

Suitable for mounting on normally flammable surfaces. 

This fitting is **IP68** rated (up to a depth of 2 metres).

Lumen Maintenance: 50,000 hours L70 at Max Ambient of 35°C.

Product & LED output code	Power Output
LD242A - RGB	350mA 3.6W (3 x 1.2W)

INSTALLATION

1. Bore clearance holes to suit dimensions below.
2. Wire the luminaire to a specified driver.

NOTE: Connections in wet environments. Make IP68 connection to stop water travelling up the cables into the fittings! Refer to IP connection sheet for further details.

3. When using **/476 Fixing Sleeve**, bond sleeve into cut-out with one of the recommended adhesives; Rotabond 2000, 3M 4200 Marine Adhesive or Simson MSR Construction Adhesive.
4. Offer luminaire up to the sleeve and push in firmly until the bezel is flush with the mounting surface.
5. When installing LD242A RGB, rotate the fitting using a grippy pair of gloves to orientate it.

DIMENSIONS

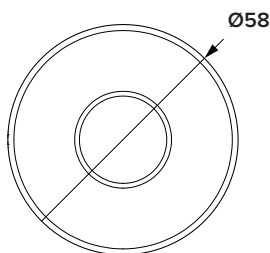

/476 Fixing Sleeve

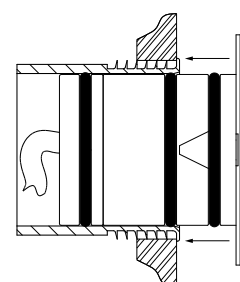
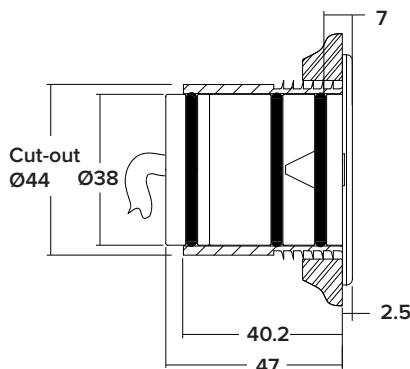
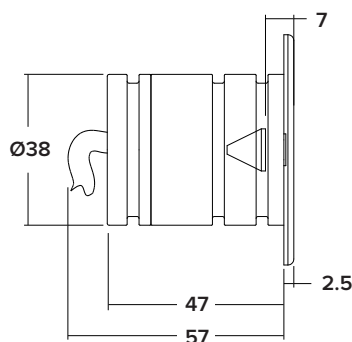

WIRING

Do not power up until fitting is wired correctly! Constant current LEDs must be wired in series, polarity is critical! Please refer to specified driver sheet for details on the minimum and maximum number of LEDs per circuit.

RGB LEDs						
LED Colour	Red		Green		Blue	
Colour of Cable	Red	Black	Green	Yellow	Blue	White
Polarity	+	-	+	-	+	-

SEE CONSTANT CURRENT WIRING SHEET FOR IN SERIES WIRING DIAGRAM

IMPORTANT

Make sure that all cables and connections are securely connected before switching on the power. Do not switch on the power source prior to making these connections as this will result in the LEDs being overvolted, which can lead to failure of the LEDs and/or the driver. If the LEDs do not work upon power up, turn off the power source immediately and check the polarity of the wiring.

MAINTENANCE

LAMPS: Non Replaceable.
O-Ring replacement part N°: 17.0049
Clean with soft damp cloth.

This leaflet should be issued and retained by the end user.

WARNING: DO NOT USE NORMAL LOW VOLTAGE TRANSFORMERS WITH LEDs.

All LED fittings are tested before dispatch. It is not necessary to check them on site. Do not power up until fittings are wired correctly.

INSTRUCTION LEAFLET



242N Concrete Housing

Concrete Housing for use with pool lights

This product should be installed by a qualified electrician in accordance with all current, local legislation. For the UK, the current edition of the IEE Wiring Regulations and European Standard IEC 60364.

DIMENSIONS

/242N Concrete box

Front

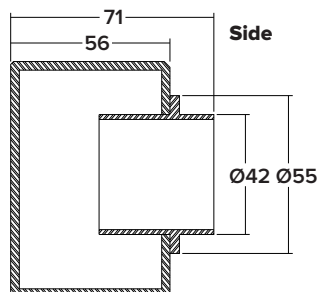
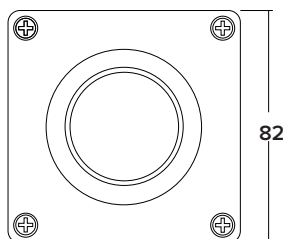

Do not power up LED or driver until all work is completed.

See 'important' section below.

INSTALLATION

1

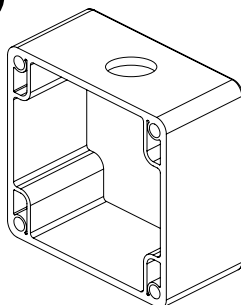

Drill conduit hole in desired location.

4

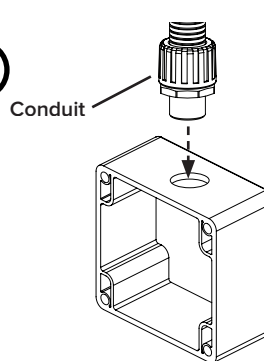

Feed conduit to 242N box

Attach conduit to box with nut and for extra security use **Rotabond 2000** to seal the join between the 242N and conduit. Allow time for Rotabond to fully cure.

Alternatively use solvent welding between the ABS box and the selected ABS conduit.

NOTE: It is strongly advised that a suitable IP rated conduit is used with the sleeve.

2

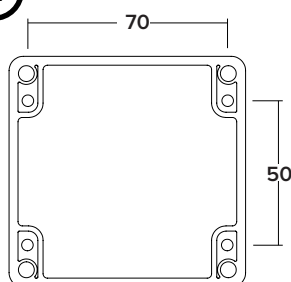

Offer up IP box against mounting surface.

5

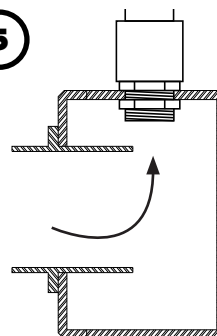

Affix front panel to the IP box using the screws provided.

After pool work has been completed, begin to feed cable to driver location. Allow excess cable to aid maintenance

NOTE: Do not make connections within the 242N.

3

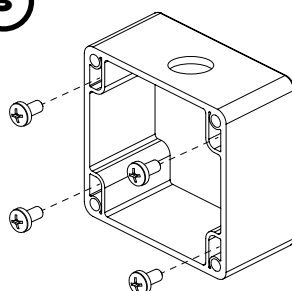

Mount to surface using pan head N°.6 or N°.8 screws.

T20414 box levels on 4 points. Pack out or use shims to level the IP box.

6

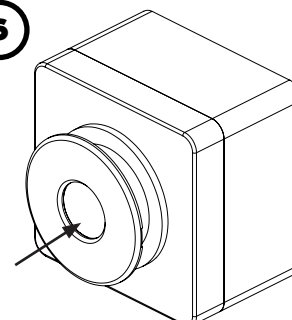

Push LED fitting into 242N, excess cable can be tucked in for any future maintenance.

IMPORTANT

Ensure that O-rings and sleeve are free of grit and dirt. Do not power on the LED or driver until all connections are completed correctly (as instructed on the relevant installation sheet/s provided). Do not excessively heat the 242N box, as high temperatures will deform box and cannot be reused.

This leaflet should be issued and retained by the end user.