

LD82-C1

Surface mounted Adjustable Spotlight



Install sheet - Page 1

SPECIFICATION

LED Surface Mounted luminaires are class III for Safety Extra Low Voltage **DC** supply. The product should only be used with a supplied or LightGraphix approved **350mA**, **500mA** and **700mA** constant current driver.

Suitable for mounting on normally flammable surfaces.

Lamp: **C1 LED Engine.**

This fitting is **IP40** rated.

Lumen Maintenance: L90B5 at 90,000hrs.

LD82 - C1	
Product & LED Output Code	Power Output
LD82-C1 - 350	350mA 1.2W
LD82-C1 - 500	500mA 1.7W
LD82-C1 - 700	700mA 2.4W

INSTALLATION

For base and/or top fixings, drill a 8mm hole in the mounting surface and feed wires through.

/PL-1

1. Cut out a Ø23mm hole in the mounting surface.
2. Wire the luminaire to a specified driver.
3. Push luminaire into mounting surface.
4. Angle head to desired position.

/SMB51

1. Fix /SMB Bracket to mounting surface.
2. Wire the luminaire to a specified driver.
3. Replace the LD82 and /SMB51 to the bracket using the provided screws.
4. Make desired adjustments to the LD82.

/ADJUSTABLE HEAD

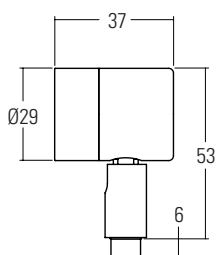

/PL-1

Fixing Plate

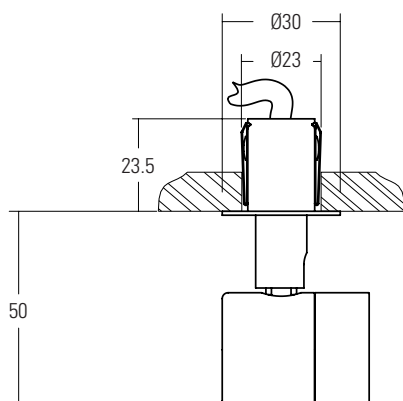

/SMB51

Surface Mounted bracket

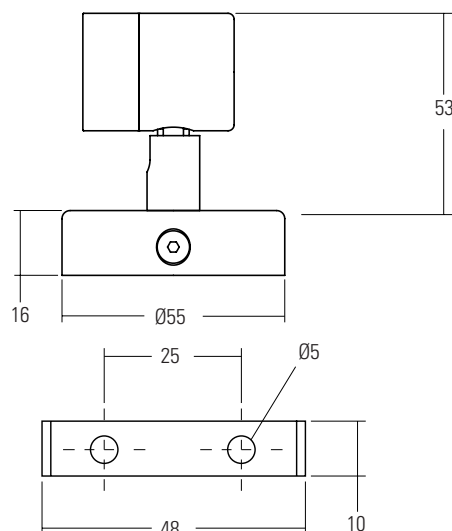

LD82-C1

Surface mounted Adjustable Spotlight



Install sheet - Page 2

SPECIFICATION

/M1

Method 1

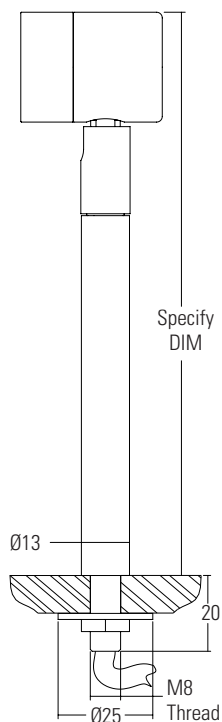

/M2

Method 2

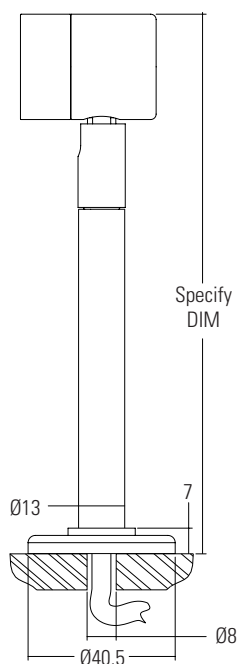

INSTALLATION

1. Create Ø8.5mm hole into the mounting surface.
2. Feed wires through hole taking care not to damage them.

/M1

1. Remove washer and nut from thread.
2. Place fitting in the hole and rotate into the desired orientation.
3. Replace washer and nut and tighten until fitting is secure.
4. Wire the luminaire to a specified driver.
5. Orientate head into the desired position.

/M2

1. Fix mounting plate to surface with 6 CSK screw.
2. Wire the luminaire to a specified driver.
3. Orientate head into the desired position.

LD82-C1

Surface mounted Adjustable Spotlight



Install sheet - Page 3

SPECIFICATION

/M3

Method 3

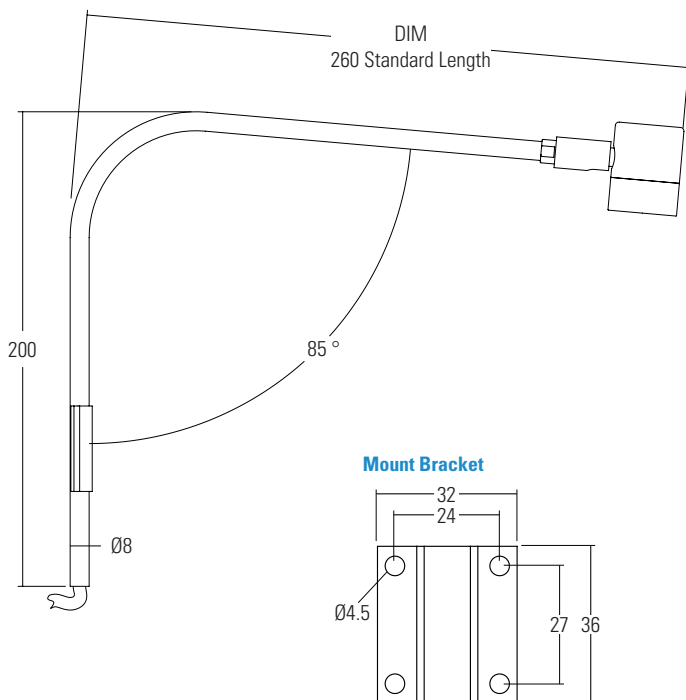

/M4

Method 4

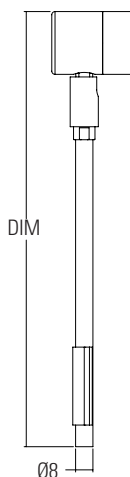

INSTALLATION

For base and/or top fixings, drill a 8mm hole in the mounting surface and feed wires through.

/M3, /M4

1. Fix mount bracket to mounting surface (wall, picture frame, etc), but do not firmly fix to surface.
2. Slide Picture Light arm and cables through the bracket, taking care not to damage the cables.
3. Tighten screws to fix the arm into position.
4. Wire the luminaire to a specified driver.
5. Orientate head into the desired position.

/E1313

1. Create a groove slightly larger than 13mm in the required location.
2. Wire the luminaire to a specified driver.
3. Either bond or screw the channel into the groove created.
4. Angle head to desired position.

/E1313

Aluminium 'U' Channel

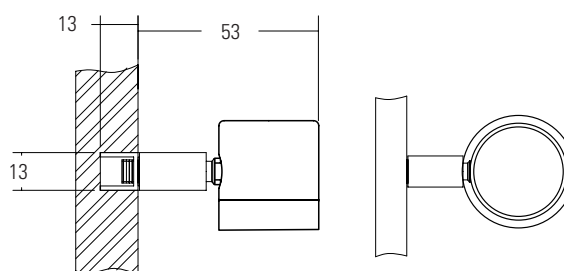

SEE CONSTANT CURRENT WIRING SHEET FOR IN SERIES WIRING DIAGRAM

WIRING

Do not power up until fitting is wired correctly! Constant current LEDs must be wired in series, polarity is critical. Please refer to specified driver sheet for details on the minimum and maximum number of LEDs per circuit.

IMPORTANT

Make sure that all cables and connections are securely connected before switching on the power. Failing to do this can lead to failure of the LEDs and/or the driver. If the LEDs do not work upon power up, turn off the power source immediately and check the polarity of the wiring. Any attempt made to open up and/or modify the luminaire will invalidate the manufacturers warranty. This is inclusive of but not limited to removal of the LightGraphix product label or removal of any parts from the main body of the product including bezels, electrical components and factory fitted fixing methods (unless otherwise stated in these instructions).

CORE COLOUR & POLARITY		
Colour of Cable	Red	Black
Materials	+	-

MAINTENANCE

Clean with soft damp cloth.
LED: Please contact LightGraphix.